

FLAP RUDDERS

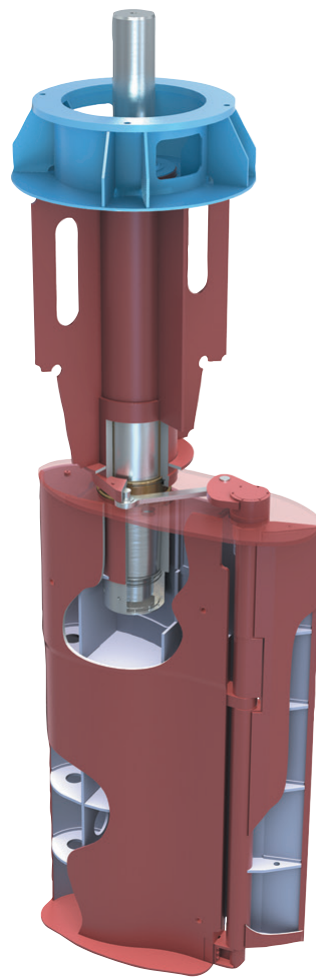

KONGSBERG



KONGSBERG FLAP RUDDERS

Rudders for high manoeuvring performance

The flap rudder is a result of intensive research and years of experience in ship construction and the manufacture of ship equipment. Shaped with a bulbous leading edge, an active flap and large vane elements, the flap rudder has superior steering and manoeuvring abilities for vessels with lower and medium speeds.

OPTIONS AVAILABLE

- Trunk with steering gear foundation
- Automatic lubrication system
- Special bearings/liners
- Heel connection module
- Wire ejector
- Special rudder solutions on request

1. Rudder trunk

Designed for minimum installation time and cost. The trunk is tailor made to suit each individual vessel.

2. Rudder stock

Made to suit all steering gears. Hydraulic taper coupling to rudder, tested and approved by class societies.

3. Flap

Connection to rudder by hinges. Welded construction as in the main rudder.

4. Flap mechanism

Well proven mechanism also at high ice classes

5. Rudder

Welded construction of certified steel. Drain plugs of stainless steel. Lifting holes arranged.

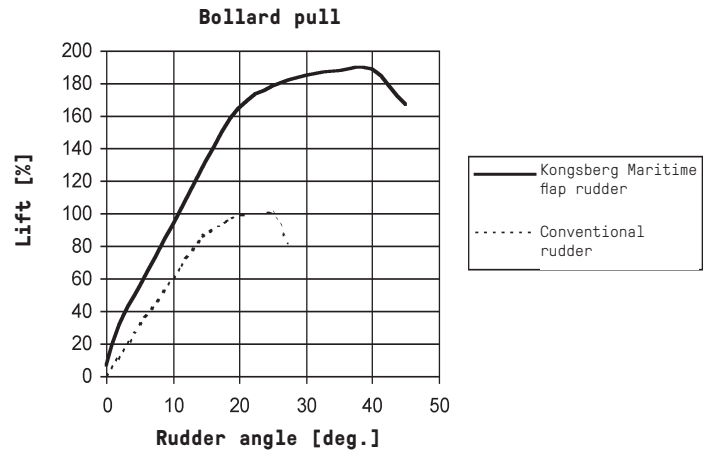
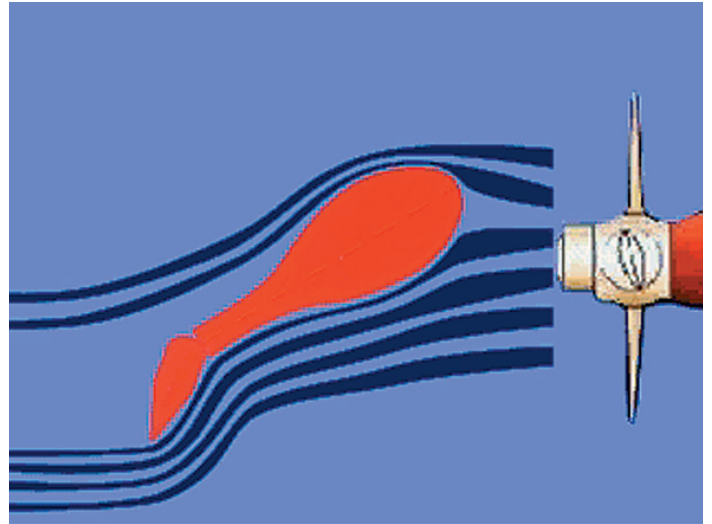
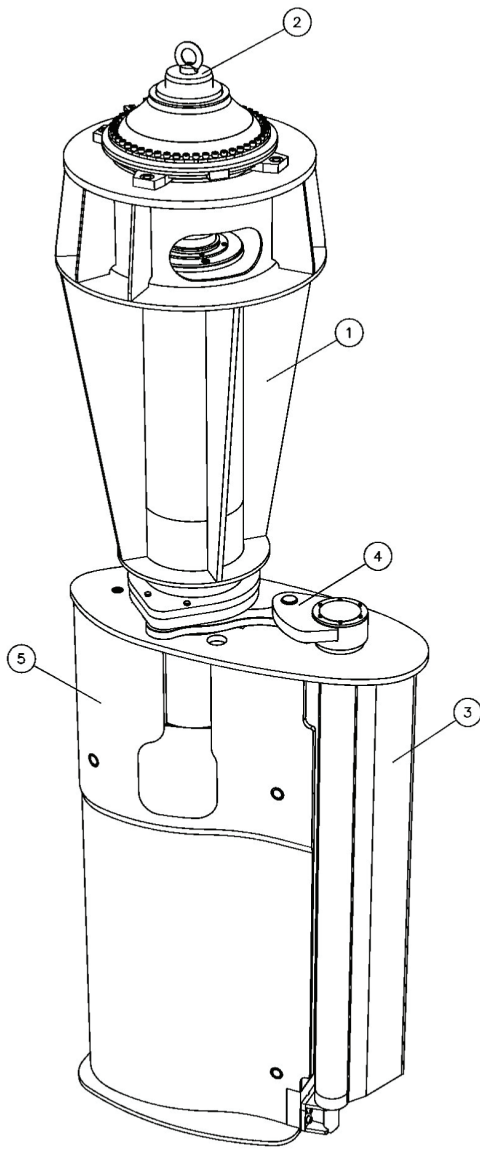

PRINCIPAL SPECIFICATION

Rudder angle	± 45°
Flap angle	± 100°
Rudder balance	approx. 34 %
Flap length	approx. 24 %
Rudder area	up to 20 m ²
Chord length	1,2-1,5-1,75- 2,0-2,33-2,7- 3,3 m
Suitable for vessel speeds	up to ~ 18 knots

